

SCALE OF 1:200 AT A2

**BIODIVERSITY PROVISION (SEE ALSO DRGS 07B, 08B, 09B)**

- SW** VIVARA PRO WOODSTONE BUILD IN SWIFT NEST BOX DEEP 3No UNDER EAVES TO EAST GABLES OF PLOTS 1 TO 6
- SP** VIVARA PRO WOODSTONE HOUSE SPARROW NEST BOX 3No TO EAST GABLES OF PLOTS 1 TO 6
- BB'C** 1B STOCK ENCLOSED BAT BOX 'C'. 1No TO WEST GABLE APX OF PLOTS 1-6
- BB'W** SCHWEGLER 1WI SUMMER & WINTER BAT BOXES. 1No TO NORTH GABLE APX OF PLOTS 7 & 8

**KEY**

- HOUSE TYPES :- (A) (B) (C)**  
 \* HANDED  
 + PROPOSED / AGREED LEVEL  
 X EXISTING LEVEL
- HIGHWAY DRAINAGE  
 --- GULLY / CONNECTION  
 --- COMBINED SEWER  
 [Hatched] AREA FOR INDIVIDUAL HOUSE SOAKAWAY  
 TESTS INDICATE HIGH POROSITY
- LIGHTING STANDARDS**  
 O EX 6M  
 ⊕ PROPOSED 6M  
 ⊗ PROPOSED 4M
- P.R.O.W. PODGEY 33. PROPOSED DIVERSION ROUTE CONTINUES A FURTHER 20M E ALONG UN-NUMBERED BRIDLEWAY (GIBRALTAR RD) THEN N ON STEPPED RAMP FOOTPATH (25M) THEN N ON PRIVATE DRIVE (5M) THEN N ON SHARED SURFACE ROAD (17M) THEN N ON STEPS TO EXISTING EXIT FROM SITE.

LANDSCAPE PLANTING SHOWN IN DETAIL ON DRG MR22-01B-101 SOFT LANDSCAPE SPEC

+ EVCPS 32AMP; TYPE 2 CONNECTIONS; MODE 3. (ON PREDICATED CIRCUIT).

CAR PARKING AREAS TO AW UNITS TO BE MIN. 6x6M. GARAGES MIN 6x3M WITH 2.6M WIDE DOORWAY; STORAGE FOR 4No CYCLES.

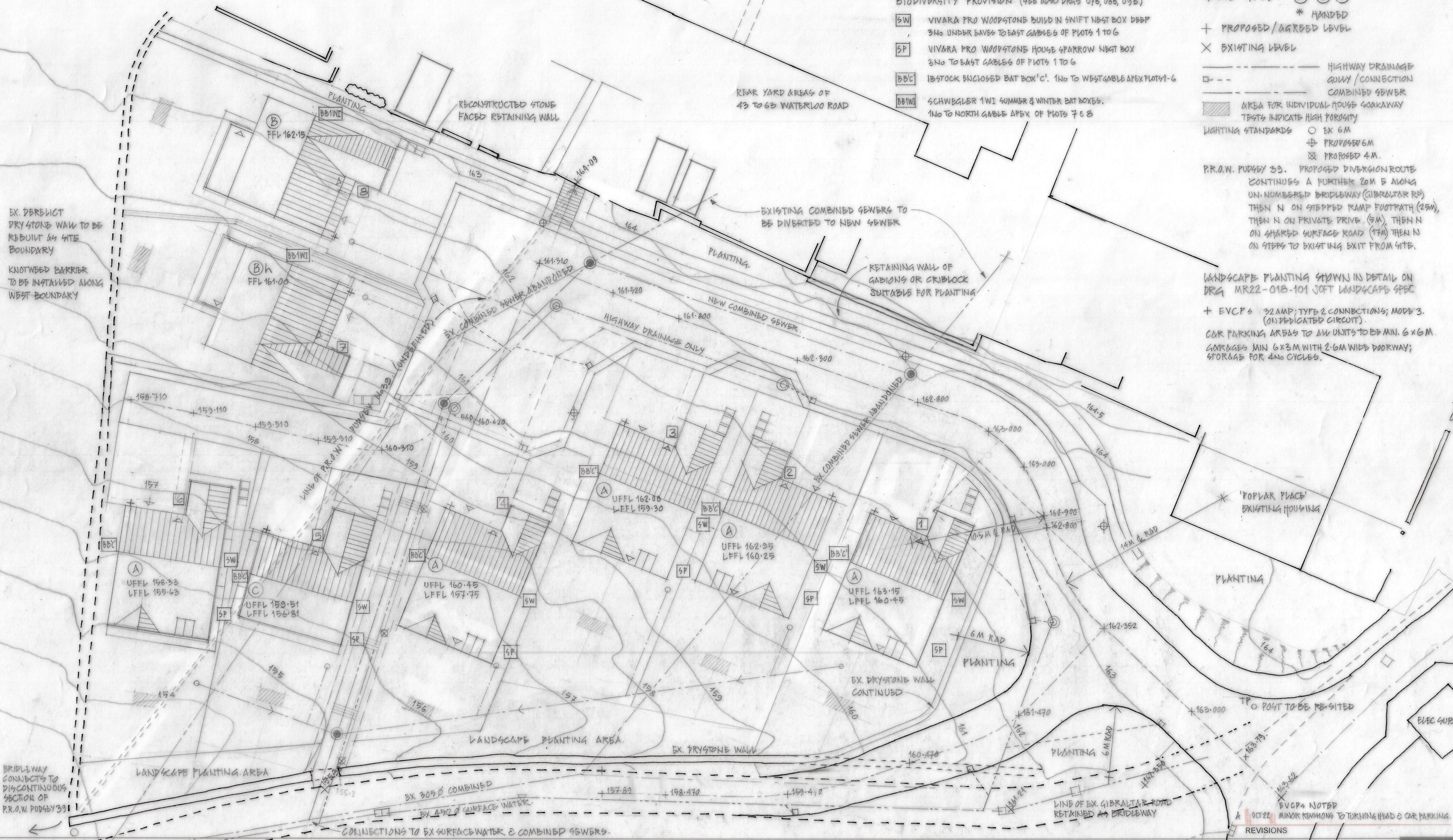

project RESIDENTIAL DEVELOPMENT AT GIBRALTAR ROAD, PUDSEY  
 client GENERAL CONTRACTORS (LEEDS) LTD  
 drawing SITE PLAN

scale 1:200 size A2  
 date JAN 2022 drawn  
 job no. A-057 drwg no. 05 revision XBC

**ALLISON & MACRAE**  
 ARCHITECTS : INTERIOR DESIGNERS  
 Burley Grange, Station Road, Burley in Wharfedale  
 Ilkley, LS29 7ND Tel 01943 862785  
 e-mail admin@allison-macrae.co.uk

REV B APR 23 BIODIVERSITY PROVISION NOTED.  
 C APR 23 LINE OF PROW AMENDED.